

Stop Check Valve

Figures 30
30½



Class 300 • Outside Screw & Yoke • Bolted Bonnet

Material of Construction*

Description	Material
Body	ASTM A216 WCB
Bonnet	ASTM A216 WCB
Disc	Hardfaced
Stem	13% Chrome
Body Gasket	Soft Steel
Body Studs	ASTM A194 B7
Body Nuts	ASTM A194 2H
Eyebolts	Carbon Steel
Groove Pins	Carbon Steel
Liner	13% Chrome
Seat	13% Chrome
Gland	13% Chrome
Gland Flange	Carbon Steel
Handwheel	Ductile Iron
Yokesleeve	Bronze

NOTE:

*Standard construction: WCB-Trim 8, other options are available.

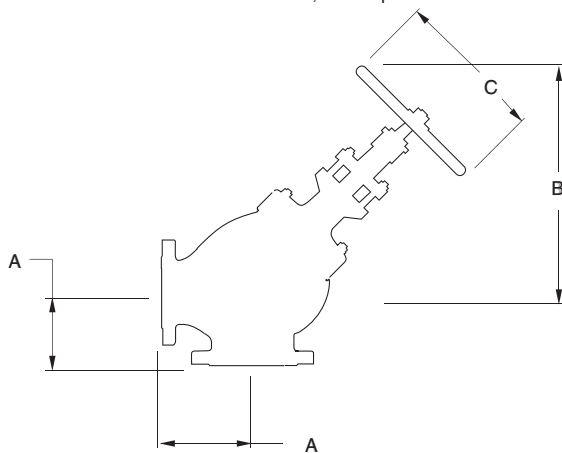

Figure 30

Flanged

Figure 30½

Butt Weld

Size Range:

3 through 10 inches
(80 - 250 mm)

Pressure Temperature Rating

Carbon Steel
ASTM A216 Grade WCB
740 psi @ -20°F to 100°F
(51 bar @ -28°C to 37°C)

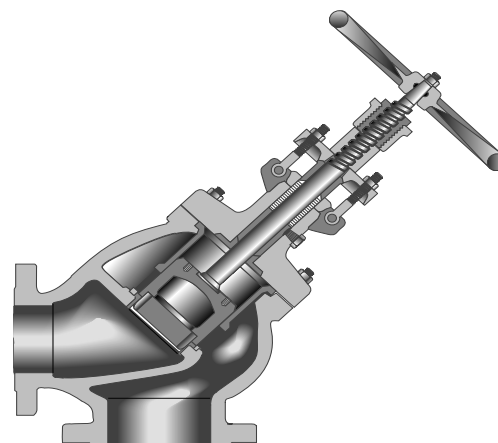

Notes

Butt weld ends on valves 10" (250 mm) and smaller are bored to match standard pipe unless otherwise specified. For larger valves, diameter (I.D. of pipe) of bore must be specified.

Industry Standards

Steel Valves	ASME B16.34
Face-to-Face/End-to-End	ASME B16.10
Flange Dimensions	ASME B16.5
Weld End	ASME B.16.25
Testing	API 598

Dimensions and Weights

Inches (millimeters) - pounds (kilograms)

Valves	3 (80)	4 (100)	6 (150)	8 (200)	10 (250)
A	6.25 (158)	7.00 (177)	8.75 (222)	10.50 (266)	12.25 (311)
B	17 (431)	21 (533)	27 (685)	32 (812)	38 (965)
C	10 (254)	14 (355)	18 (457)	20 (508)	30 (762)
Wt. (30)	120 (54)	200 (90)	370 (167)	680 (308)	1120 (508)
Wt. (30½)	90 (40)	160 (72)	320 (145)	570 (258)	970 (439)